

*Adache Perspective is a periodic corporate newsletter published by Adache Group Architects to inform their clients, prospective Clients, and friends of their current architectural and interior design projects.*



**ORA HOTEL & RESIDENCES - TAMPA, FL**



**MOON RESIDENCES - HOLLYWOOD, FL**

## adache group architects

### ARCHITECTURAL DESIGN IN SOUTH FLORIDA: A FUSION OF STYLE AND FUNCTIONALITY

South Florida's architectural design is a vibrant blend of influences, reflecting the region's rich cultural diversity, tropical climate, and coastal landscape. Known for its iconic Art Deco style, especially in Miami Beach, the area boasts pastel-colored facades, geometric patterns, and sleek curves that evoke the glamour of the 1930s and 1940s.

Beyond Art Deco, South Florida is home to a variety of architectural styles. Mediterranean Revival, with its terracotta roofs, stucco walls, and arched windows, has been a staple since the early 20th century, blending Old World charm with modern luxury. Contemporary architecture is also on the rise, characterized by minimalist designs, clean lines, and a focus on indoor-outdoor living. Floor-to-ceiling windows, open floor plans, and sustainable materials are common features, taking advantage of the region's abundant natural light and ocean views.

Adaptation to the climate is a key element in South Florida's architecture. Elevated structures, hurricane-resistant materials, and innovative drainage systems address challenges like flooding and storms. Additionally, tropical landscaping and shaded outdoor spaces are integral to creating a seamless connection between nature and design.

Adache Group Architects expertly incorporates these elements into its projects and is known for their work in hospitality, condos, and mixed-use developments. Adache Group Architects draws significant inspiration from South Florida's architectural heritage. Continued on page 4...

### ORA HOTEL & RESIDENCES TAMPA, FLORIDA

Adache Group Architects has unveiled the design for the ORA Hotel and Residences, a 39-story tower in Tampa, Florida. Floors 17 to 35 will feature hotel-condo units, with the top four floors reserved for 31 private residences. The remaining floors will house hotel rooms. ORA will cater to convention groups, vacationers, and business travelers, while also serving as a destination for weddings, sporting events, and special occasions. The development boasts over 45,000 square feet of amenities, including a 15,000-square-foot convention space, a 10,000-square-foot signature restaurant, a fitness center with a steam room, a swimming pool, and even a rooftop helipad. ORA promises a luxury experience designed to meet the needs of both residents and guests, positioning itself as a premier destination in the heart of Tampa.

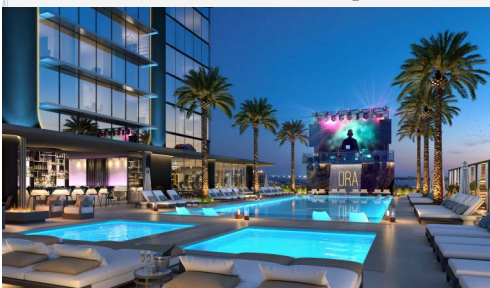

### MOON RESIDENCES HOLLYWOOD, FLORIDA

Moon Condominiums, a six-story residential development, offers 48 luxury units just steps from the popular Hollywood Beach Boardwalk. The building is designed and positioned to maximize views of the Intracoastal Waterway and the Atlantic Ocean. With its elegant flowing curves, its form invokes a sense of calm sophistication. This native aesthetic brings forth the concept of tropical and natural elements to infiltrate the design in aspects such as colors, exterior and interior environments and a pool deck and terraces that all act as an extension to of the beach, waterways and dunes. The mixture of subtle beige, white, and natural wood finishes, along with the curved architectural facades and balconies work together to provide a tropical yet modern design appropriately situated in a city known for its beach life.

Residents will enjoy a host of premium amenities, including a multi-level deck with a pool, outdoor bar, fitness center, spa, business center, and clubroom with a chef's kitchen.



## HARBOR BEACH CONDOS FORT LAUDERDALE, FL



Adache is the Architect of Record for the Harbor Beach Condos, a luxury residential development designed by New York-based Kora Architects. This 22-story tower will have 36 exclusive condominium units, featuring a modern yet timeless design characterized by soft curves, natural materials, and floor-to-ceiling glass for a seamless connection between indoor and outdoor spaces. Residents will enjoy an array of top-tier amenities on the seventh-floor deck, including a resort-style pool, poolside bar, private cabanas, a social club, game room, gym, and wellness center. The residences, starting on the fifth floor, offer breathtaking views—westward to the Intracoastal Waterway and eastward to the Atlantic Ocean. Unit sizes range from 1,836 to 3,723 square feet. At the pinnacle, two stunning two-story penthouses span 9,470 and 9,664 square feet, each featuring a private rooftop spa, delivering the ultimate in luxury living.

## YOTEL HOTEL ORLANDO, FL

Adache Group Architects is bringing its expertise to the vibrant city of Orlando with the design of the new YOTEL Hotel at 47 W Jefferson Street. Scheduled to feature 253 rooms, the hotel stays true to YOTEL's signature style, blending compact, modern accommodations with high-tech amenities and a sleek design aesthetic. YOTEL hotels are globally recognized for their distinctly small yet efficient room layouts, enhanced by a signature purple color palette and innovative lighting that create a futuristic and inviting ambience.

The Orlando location will incorporate these elements while embracing a modern design tailored to the city's dynamic energy. A standout feature of the hotel is its rooftop lounge, offering guests a sophisticated space to relax and enjoy views of downtown Orlando. This new addition not only elevates the city's hospitality offerings but also highlights Adache's commitment to delivering cutting-edge, experiential design.



## ADRIA RESIDENCES FORT LAUDERDALE, FL

Adria Condominiums, a five-story residential project, is coming to 90 Isle of Venice Drive along the Rio Cervante Waterway. Designed by Adache Group Architects, the 28,238-square-foot building will house eight upscale units, with two per floor. Each unit will offer four bedrooms across 2,961 or 2,977 square feet, featuring high-end finishes. Built on a 0.33-acre site zoned for medium-high-density residential use (RMM-25), Adria will showcase a contemporary design with white and gray stucco, glass railings, aluminum mullions, limestone and coral stone veneer, and perforated aluminum panels. A ground-level garage with vertical slats and pedestrian-friendly landscaping will enhance the streetscape.

Residents will enjoy a swim spa deck, lounge seating, a barbecue area, and a boat dock. Each unit will also have a private rooftop patio, ranging from 418 to 747 square feet. The developer is seeking reduced setbacks—21 feet in the front and 17 to 20 feet on the sides and rear—to allow for a pool and deck near the waterway.



### ADACHE CONSISTENTLY AWARDED TOP DESIGN FIRM



**UNDER CONSTRUCTION**



**BREAD BUILDING - HOLLYWOOD, FL**



**ONE TAMPA - TAMPA, FL**



**SERENE RESIDENCES - FORT LAUDERDALE**



**HOME 2 SUITES - PLANTATION**



**TOWNE PLACE SUITES - CLEWISTON**



**COURTYARD MARRIOTT - HOLLYWOOD, FL**

**CANOPY HOTEL - FORT LAUDERDALE, FL**

The 11 story, 169 room Canopy Hotel is situated just a few blocks north of Las Olas Blvd. The Canopy brand, falls into the upscale select service category. And the Homewood brand is a leader in upscale limited-service accommodations. The design employs warm color palettes and decorative cladding to accentuate the porte-cochère. The vehicular garage incorporates multiple vertical aluminum panel screening elements of varying widths, creating an illusion of movement for passersby on foot or in vehicles. The ground floor is thoughtfully designed, featuring a spacious guest lobby that connects to an inviting outdoor patio. The hotel's amenities include a fitness center, a café, a bar, a market, a fourth-level pool deck, guest laundry facilities, a meeting room, and a stylishly designed lobby space. The Canopy hotel promises a luxurious and satisfying experience for its guests.

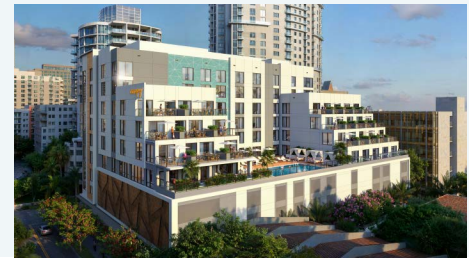

**HOTEL 42 - FORT LAUDERDALE, FL**

Hotel 42, situated on the picturesque Fort Lauderdale Beach, this 15-story hotel is set to offer 75 guest rooms. Featuring a captivating "sky lobby" on the fifth floor, extending gracefully over two stories, providing breathtaking views of the ocean and the Intracoastal Waterway. The building's design is characterized by a fin-like architectural element that runs throughout the structure, culminating at the 15th-level amenity deck rooftop.

The fifth floor offers an array of amenities, including an outdoor terrace with seating areas and a cozy fire pit, an indoor lobby seating area, a lounge, and an exclusive bar reserved for guests. On the 15th floor, guests can relax on the pool deck with cabanas, lounge seating, and a food service area with a cafe restaurant.



**ATLAS AIR HOTEL - FORT LAUDERDALE, FL**

Atlas Air is a state-of-the-art facility designed exclusively for student pilots. This project features a pilot simulation aviation center and an eight-story, 175-key hotel, ensuring a seamless, focused environment for aviation training. The design features sleek, modern lines complemented by natural stone and accented with warm wood elements. Floor-to-ceiling windows take center stage, enhancing the connection between indoor and outdoor spaces, resulting in a timeless and sophisticated aesthetic.

Key amenities cater to long-term stays, including a swimming pool, BBQ area, restaurant and bar, gym, business center, and guest lounges. Each guestroom is equipped with a kitchenette featuring an electric cooktop, refrigerator, microwave, sink, and dishwasher. Designed for functionality and comfort, Atlas Air sets a new benchmark for aviation education, providing student pilots with an optimal training and living environment.



### PIER 66 - PELICAN LANDING - FORT LAUDERDALE, FL

The newly reimagined Pelican Landing at Pier 66 Marina is set to make a striking return in 2025, boasting a modern rustic design that seamlessly blends nautical elegance with contemporary architecture. Designed by Adache, the new two-level restaurant will showcase a thoughtfully curated blend of natural materials, warm wood tones, and industrial accents, creating a space that feels both inviting and refined.

Expansive indoor and outdoor seating will immerse guests in the beauty of the Intracoastal Waterway, offering unparalleled views of the 17th Street Causeway Bridge. The open-air bar area, framed by exposed beams and coastal-inspired textures, will provide the perfect setting to watch yachts glide by. Whether arriving by boat or car, visitors will step into a stylish yet relaxed environment that reflects the effortless charm of Fort Lauderdale's waterfront lifestyle.



### ADACHE'S INTERIOR DESIGN TEAM

Adache's interior design team create spaces for living and working that are innovative not only from a visual impact but also for health, comfort, flexibility and ease of use. How a place makes us feel is paramount and Adache's designers understand the power of this emotional connection. Our team specializes in all types of projects from new construction, renovation or adaptive reuse and our focus is on creating experiences that exceed our client's expectations.



### OLD TOWN II TOWERS - POMPANO BEACH, FL

Building on the success of the first Old Town Square Apartment project, the upcoming Old Town II Towers will further enhance the evolving Old Town Pompano Beach neighborhood with a thoughtfully designed residential expansion. Developed by Adam Adache of Cavache Properties, Old Town II will feature two architecturally distinct buildings connected by a pedestrian bridge, seamlessly integrating modern living with the vibrant surroundings.

The development will consist of a 10-story tower with 229 residences and a six-story building offering 90 units, totaling 319 thoughtfully designed apartments ranging from one- to three-bedroom layouts. Residents will enjoy an array of high-end communal amenities, including a sixth-floor swimming pool with scenic views, a pet park, a bike shop, and a movie room, fostering a dynamic and engaging community atmosphere. This next phase of development promises to elevate urban living in Pompano Beach, blending modern convenience with a vibrant, walkable community.



Continued from page 1...Moreover, Adache Group Architects embraces sustainability, utilizing energy-efficient materials and designs that mitigate environmental impact while enhancing aesthetic appeal. Our projects often integrate lush landscaping, waterfront elements, and panoramic views that celebrate the beauty of South Florida's coastal environment. By blending tradition with modern innovation, they continue to shape the architectural landscape, crafting spaces that embody the essence of the region while meeting the needs of contemporary living. From luxury waterfront estates to urban high-rises, South Florida's architectural design continues to evolve, blending tradition with innovation to meet the needs of its dynamic and growing population. It's a testament to creativity shaped by nature and culture, and firms like Adache Group Architects play a pivotal role in carrying this legacy forward.

*"As an architect you design for the present, with an awareness of the past, for a future which is essentially unknown."*

*- Norman Foster*

**adache**  
group architects

550 S Federal Highway  
Ft. Lauderdale, FL  
33301  
p: 954.525.8133  
[www.adache.com](http://www.adache.com)  
FL License  
#AA13000579

CONNECT  
WITH ADACHE

